

## 1 CLEANING

Rinse gel with PBS and add cell culture medium

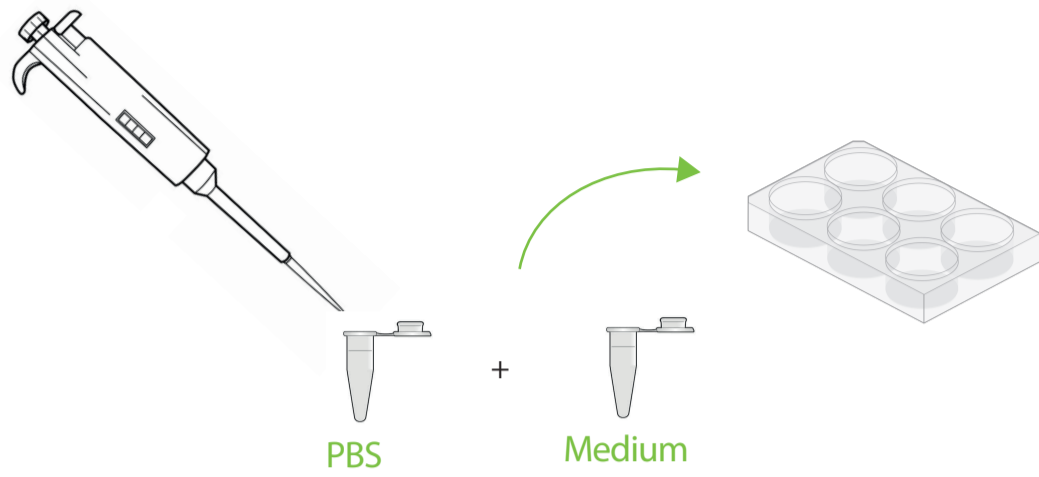

## 2 EQUILIBRATE THE GEL

Incubate 15 min with cell culture medium at 37°C

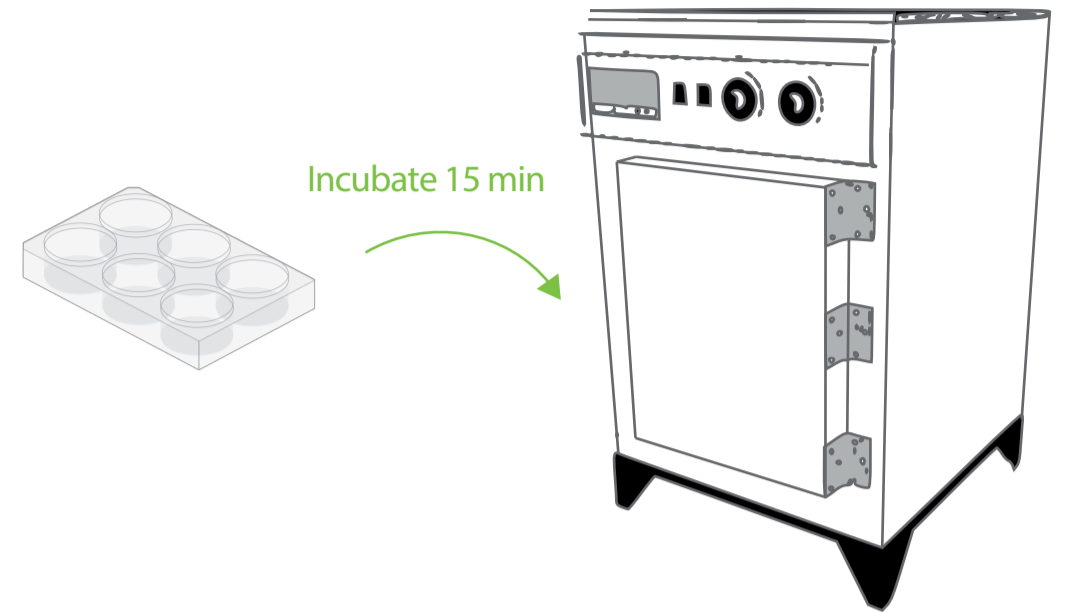

## 3 CELLS PLATING

Add cell suspension to the gel

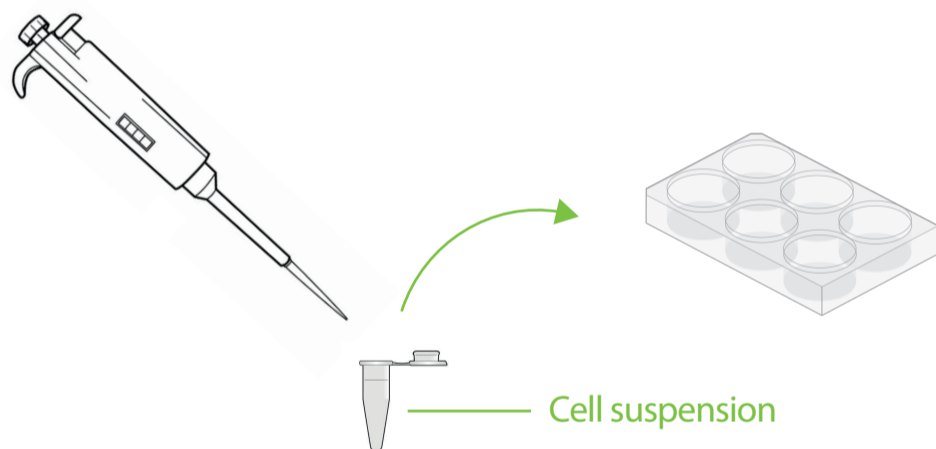

## 4 CELLS INCUBATION

Incubate cells in the dish for 1h at 37°C – Cell adherence

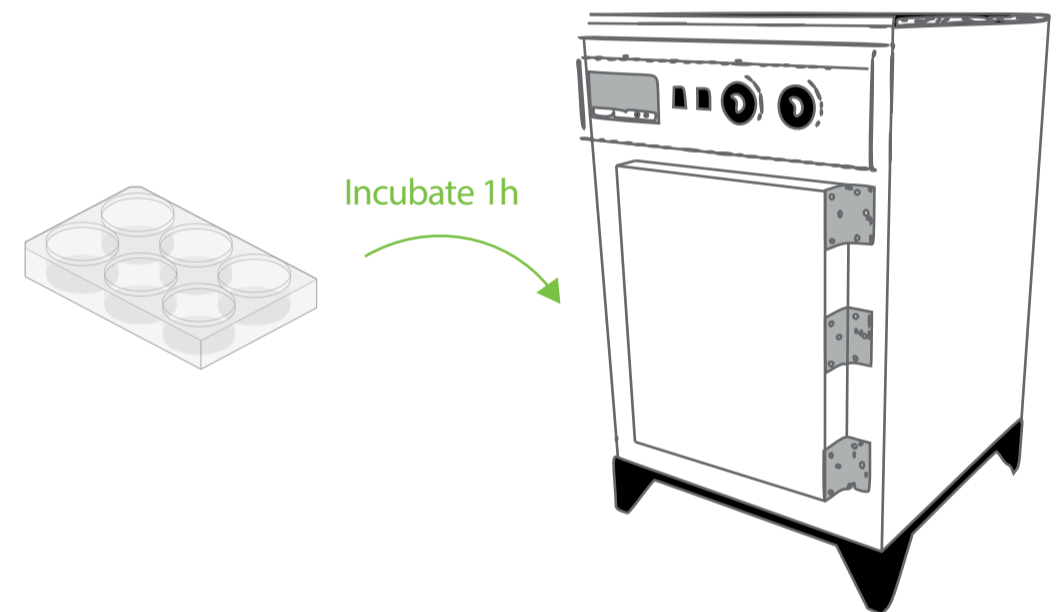

## 5 UNATTACHED CELLS REMOVAL

Wash unattached cells with fresh pre-warmed cell culture medium or PBS

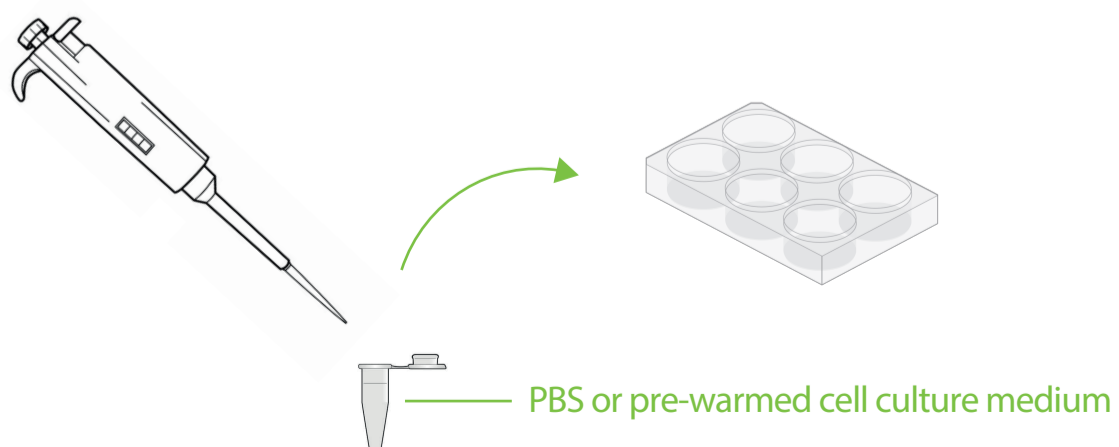

## 6 OBSERVATION

Observe cells after overnight incubation

