

## 1 CLEANING

Rinse gel with PBS and add cell culture medium

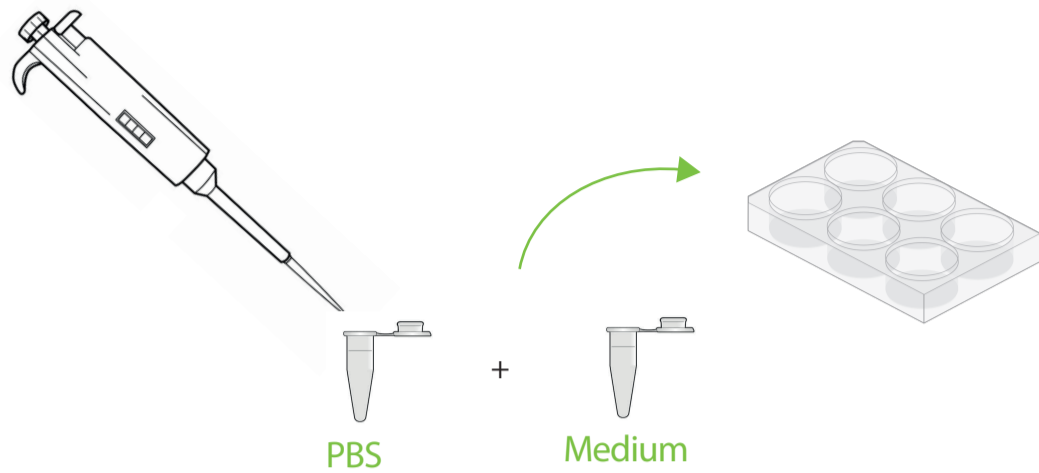

## 2 EQUILIBRATE THE GEL

Incubate 15 min with cell culture medium at 37°C

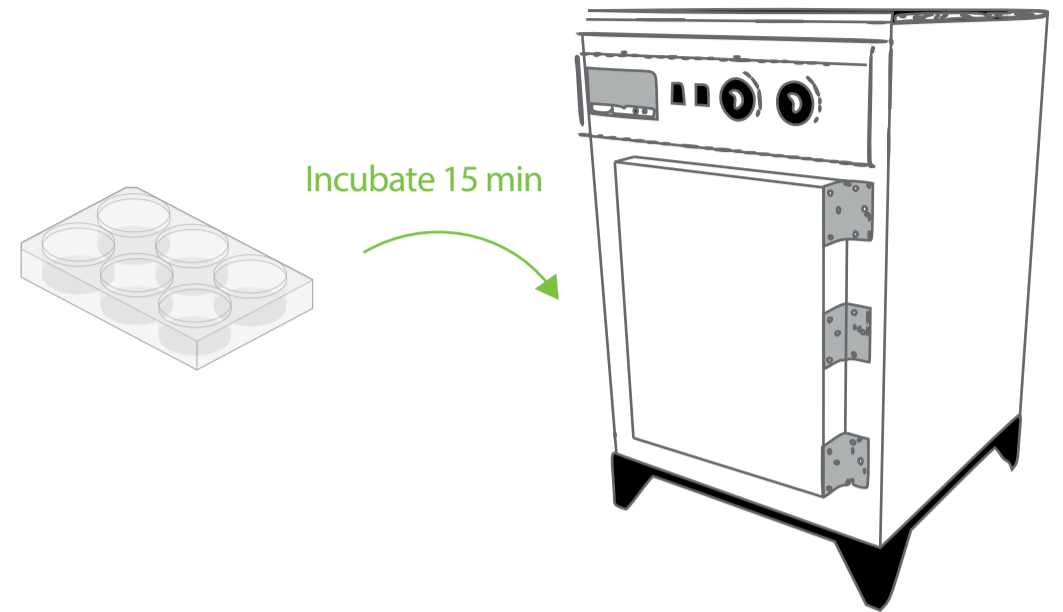

## 3 CELL PLATING

Add cell suspension to the gel

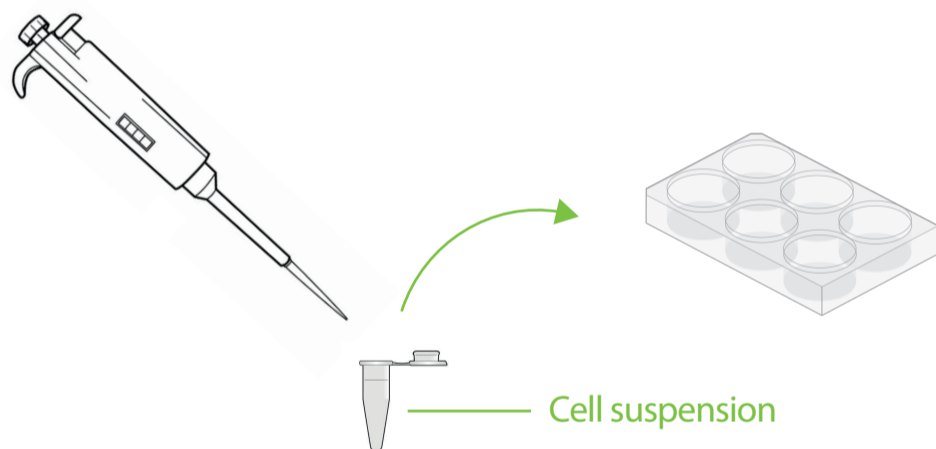

## 4 CELL SEDIMENTATION & AGGREGATION

Incubate cells in the dish for 1h at 37°C to allow the cells to sediment and aggregate

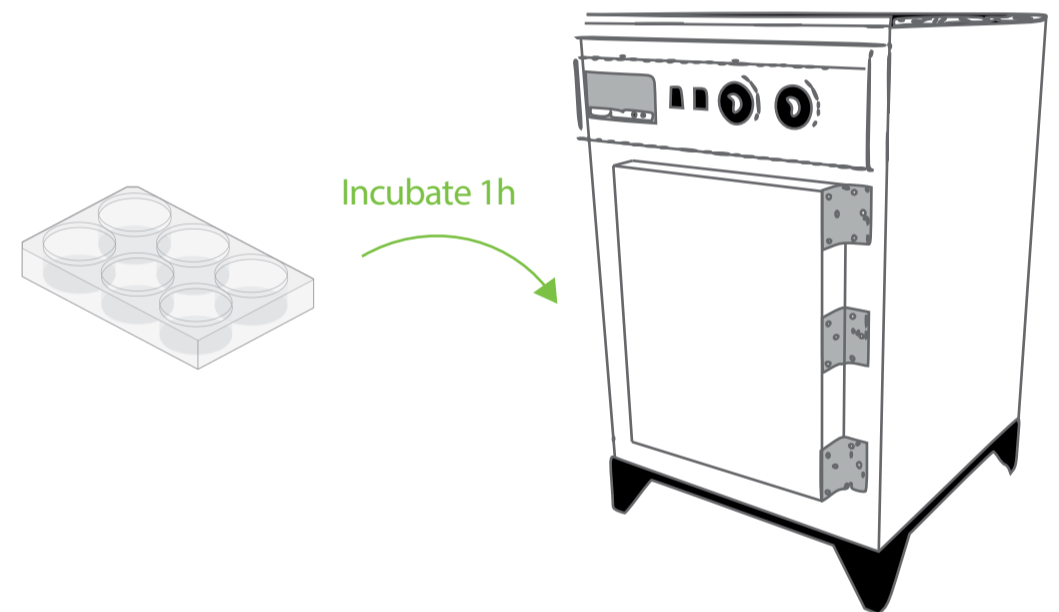

## 5 ADD ADDITIONAL MEDIUM

Add 2mL of medium to the macro-well for overnight incubation

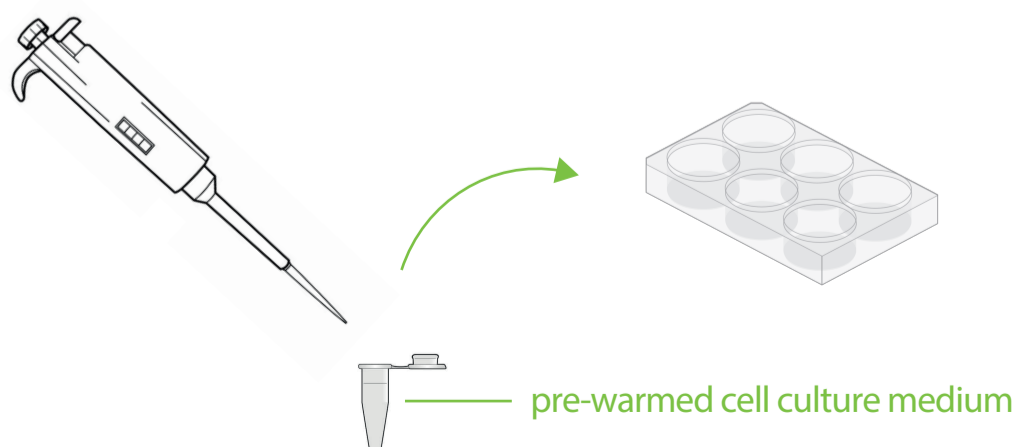

## 6 OBSERVATION

Observe cells after overnight incubation

